

ALDRICH RESIDENCE

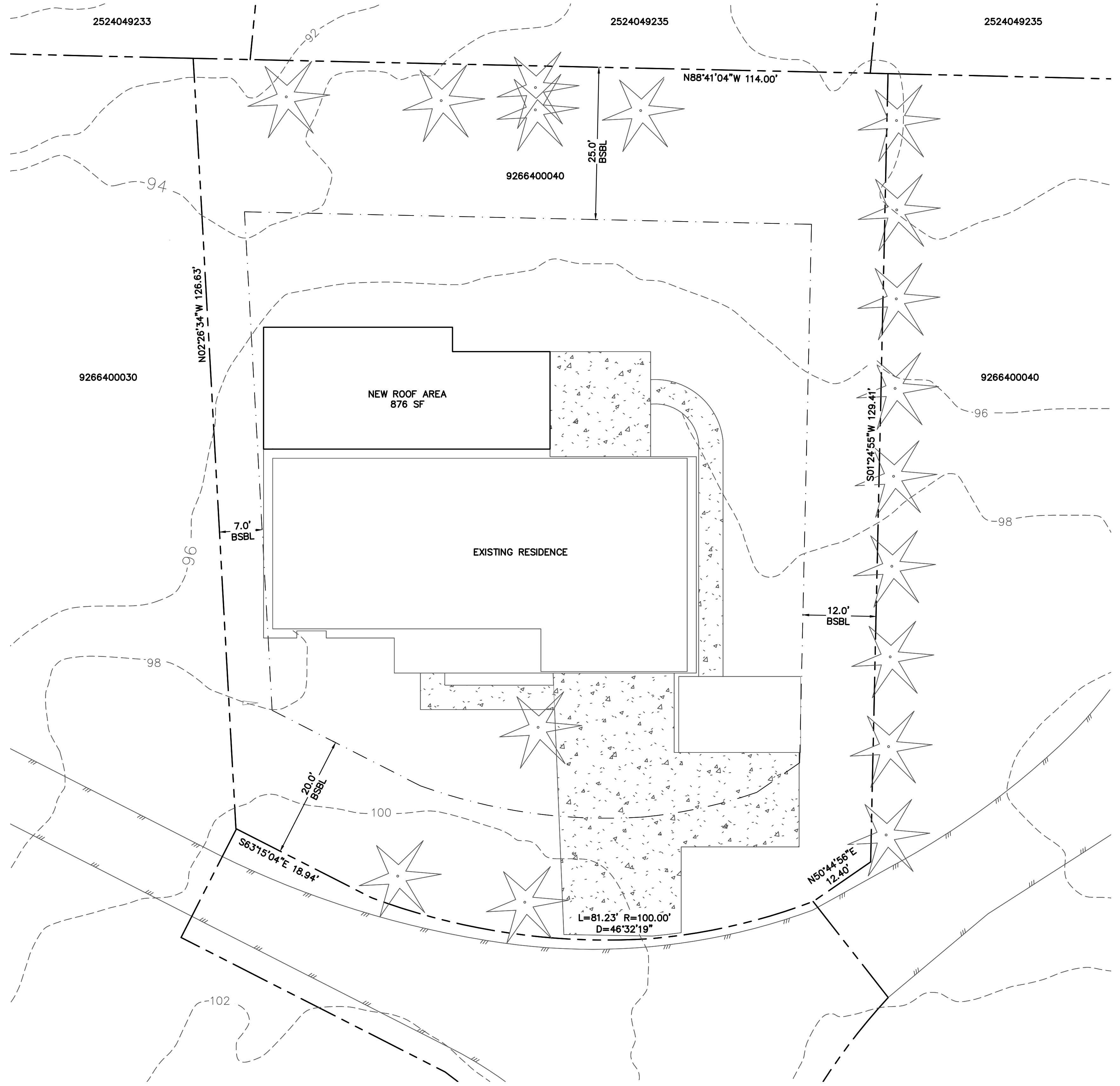

VICINITY MAP

SITE INFORMATION

ADDRESS - 7448 W MERCER WAY, MERCER ISLAND WA, 98040
 TAX PARCEL - 9266400040
 ZONING - R15
 PARCEL AREA - 15,195 SF (0.35 ACRES)
 OWNER - JAMES AND BROOKE ALDRICH

SHEET INDEX	
SHEET	DESCRIPTION
1	COVER SHEET
2	TESC PLAN
3	GRADING AND DRAINAGE PLAN

IMPERVIOUS SURFACES

BUILDING WITH ROOF OVERHANG, EXISTING = 2,450 SF
 DRIVEWAY, EXISTING = 1,151 SF
 WALKWAY, EXISTING = 307 SF
 PATIO, BACK, EXISTING = 285 SF
 STORAGE SHED, EXISTING = 250 SF
 ADDITION, NEW WITH ROOF OVERHANG = 876 SF

TOTAL IMPERVIOUS SURFACE = 5,319 SF (35.00%)

LEGEND

- EDGE OF PAVEMENT
- RIGHT-OF-WAY/PROPERTY LINE
- BUILDING SETBACK LINE
- EXISTING CONTOUR
- EXISTING TREE
- EXISTING CONCRETE
- SOIL AMENDMENT
- STORM DRAIN CLEAN OUT
- STORM DRAIN SPLASH BLOCK
- STORM DRAIN FLOW PATH

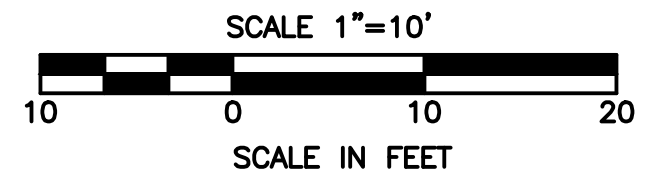

CALL 2 DAYS BEFORE YOU DIG
 1-800-424-5555

REVISIONS	
NO.	DESCRIPTION
1	
2	
3	
4	
5	
6	

5/JUL/2025

ALDRICH RESIDENCE

COVER SHEET

PROJECT NO:	N/A
SURVEYED BY:	GIS
DESIGNED BY:	DAW
DRAWN BY:	DAW
CHECKED BY:	DG
DATE:	5/JUL/2025

1 OF 3

ALDRICH RESIDENCE

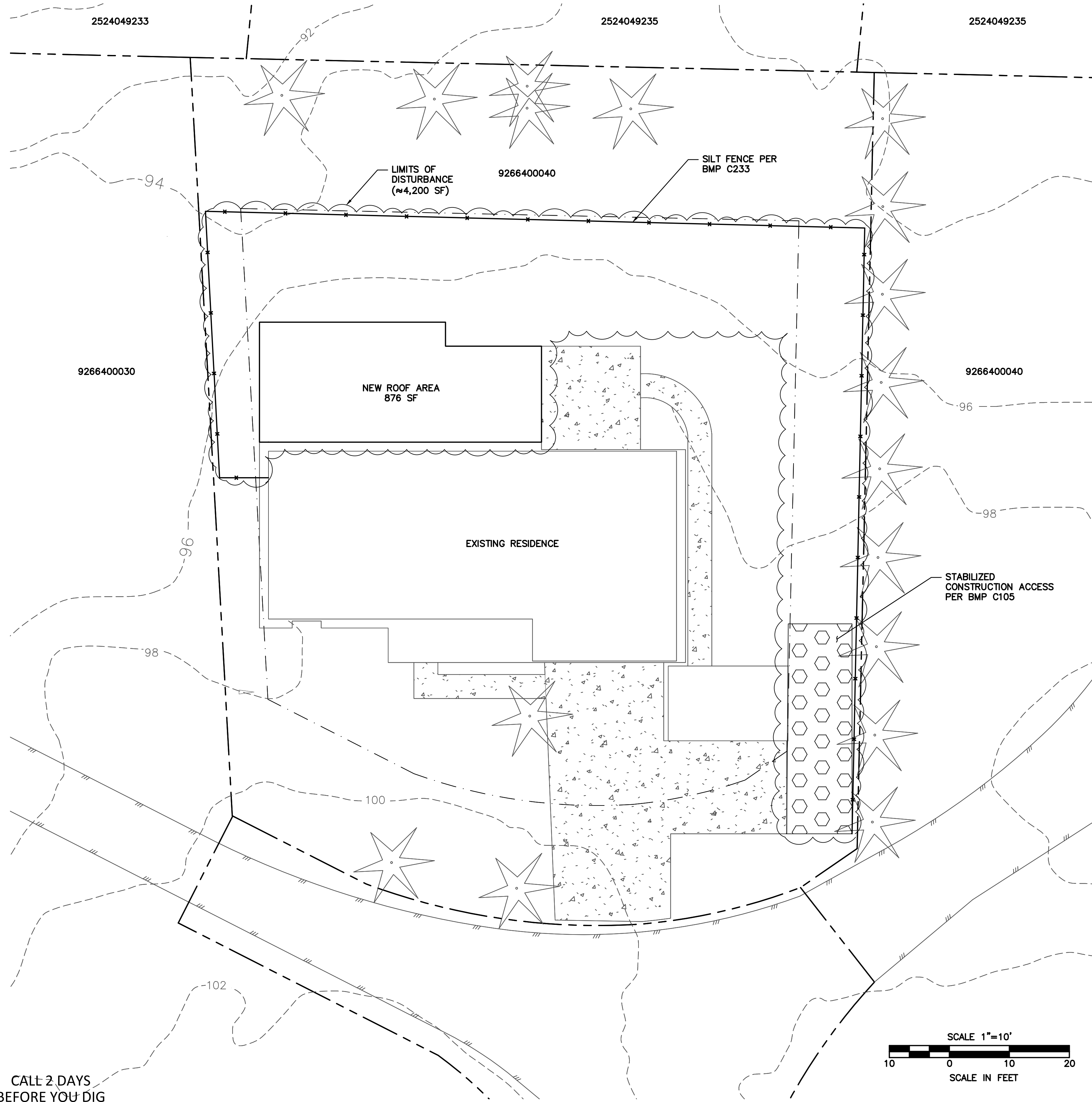

CALL 2 DAYS
BEFORE YOU DIG
1-800-424-5555

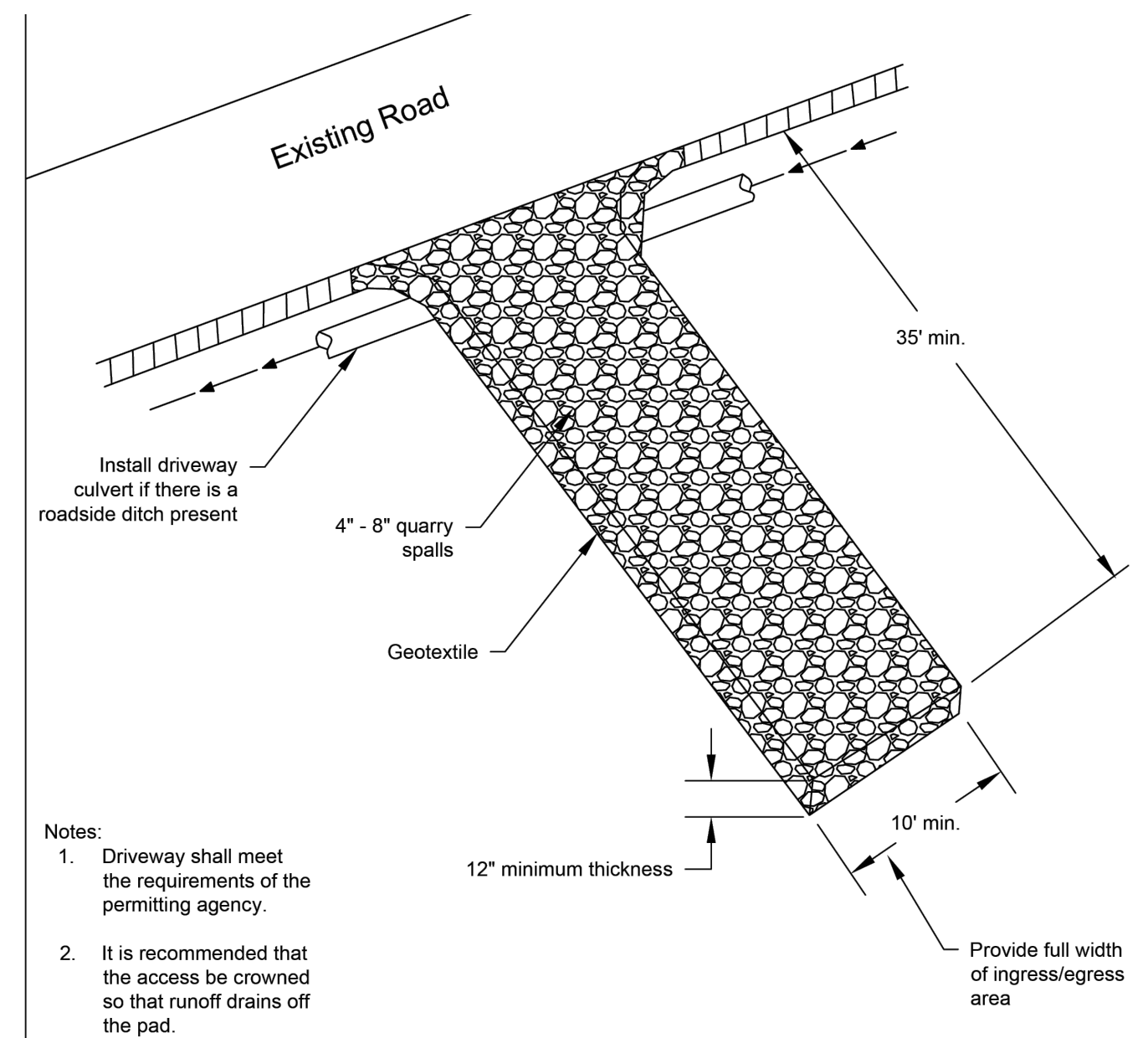
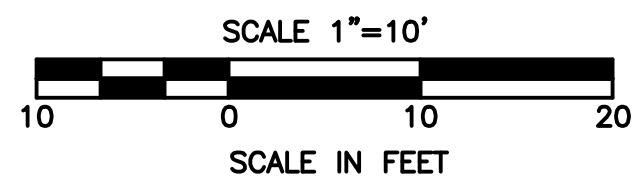

STABILIZED CONSTRUCTION ENTRANCE
NOT TO SCALE

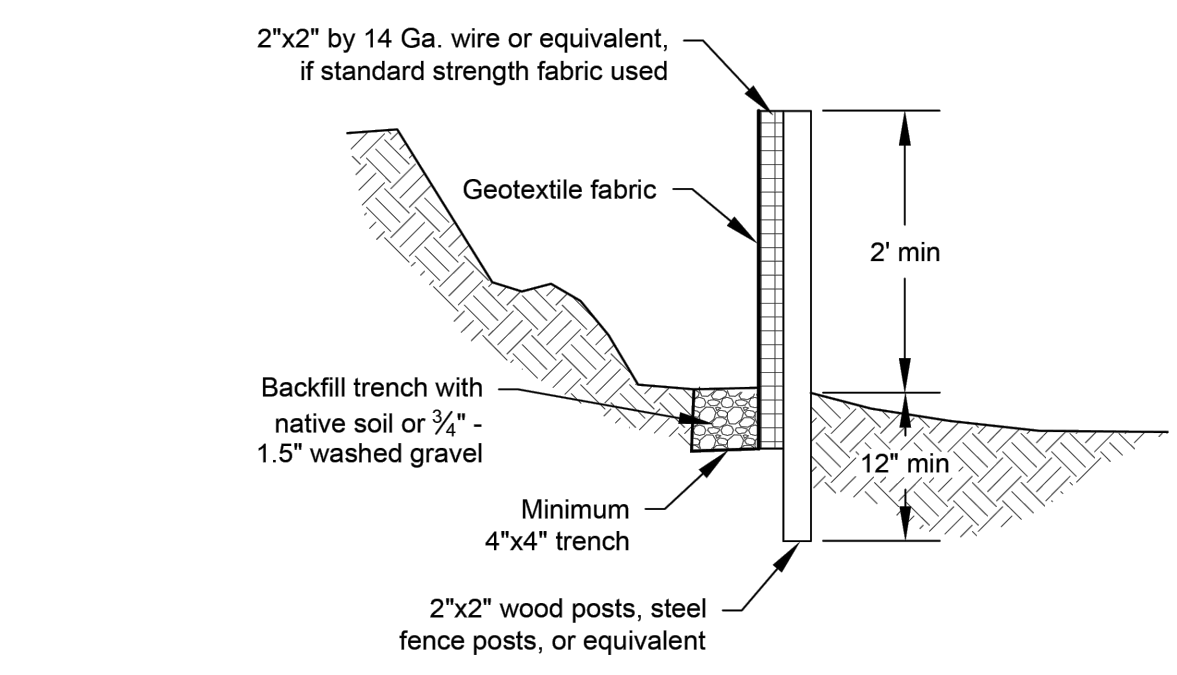
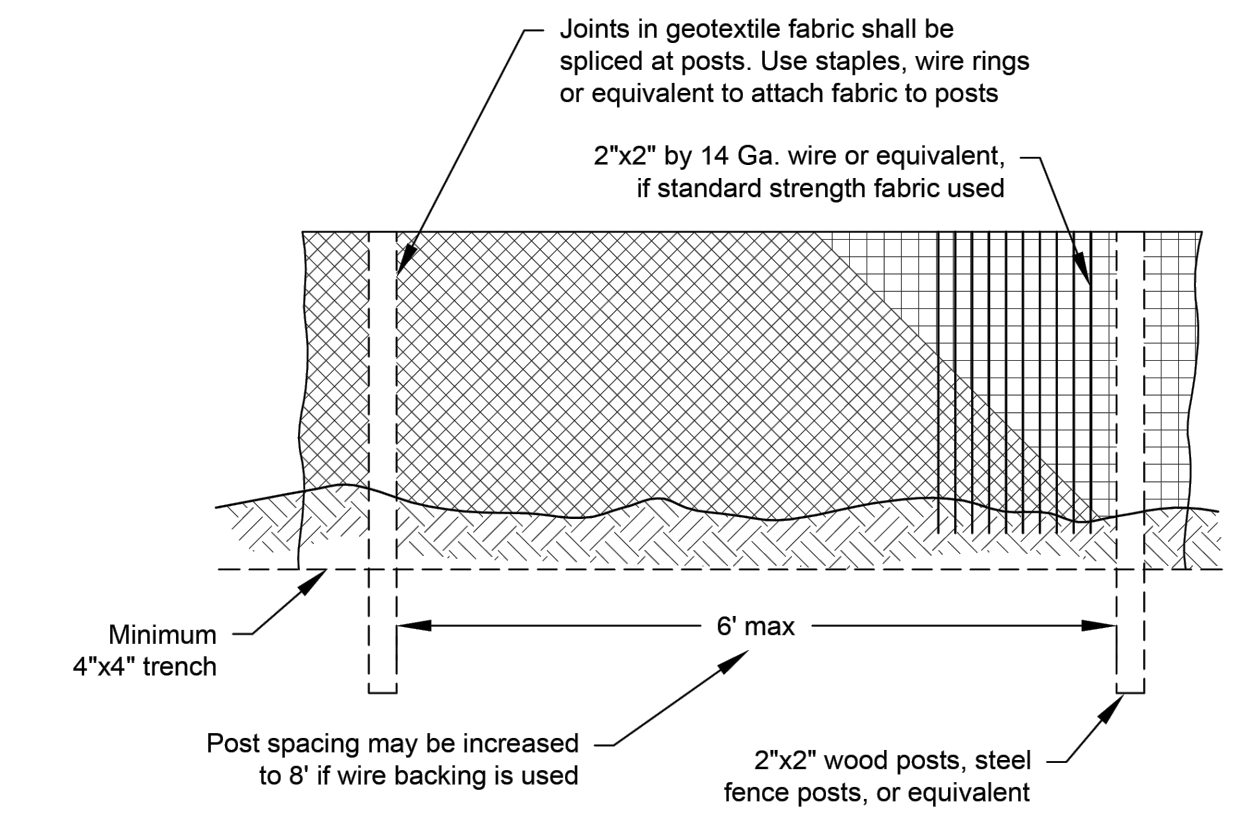

SILT FENCE
NOT TO SCALE

REVISIONS	
NO.	DESCRIPTION
1	
2	
3	
4	
5	
6	

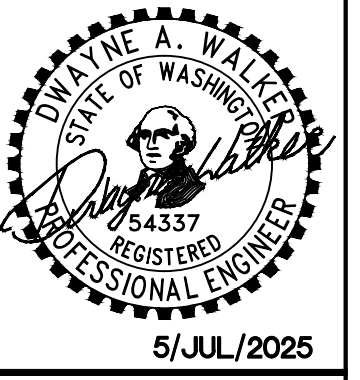

ALDRICH RESIDENCE TESC PLAN

PROJECT NO:	N/A
SURVEYED BY:	GIS
DESIGNED BY:	DAW
DRAWN BY:	DAW
CHECKED BY:	DG
DATE:	5/JUL/2025

ALDRICH RESIDENCE

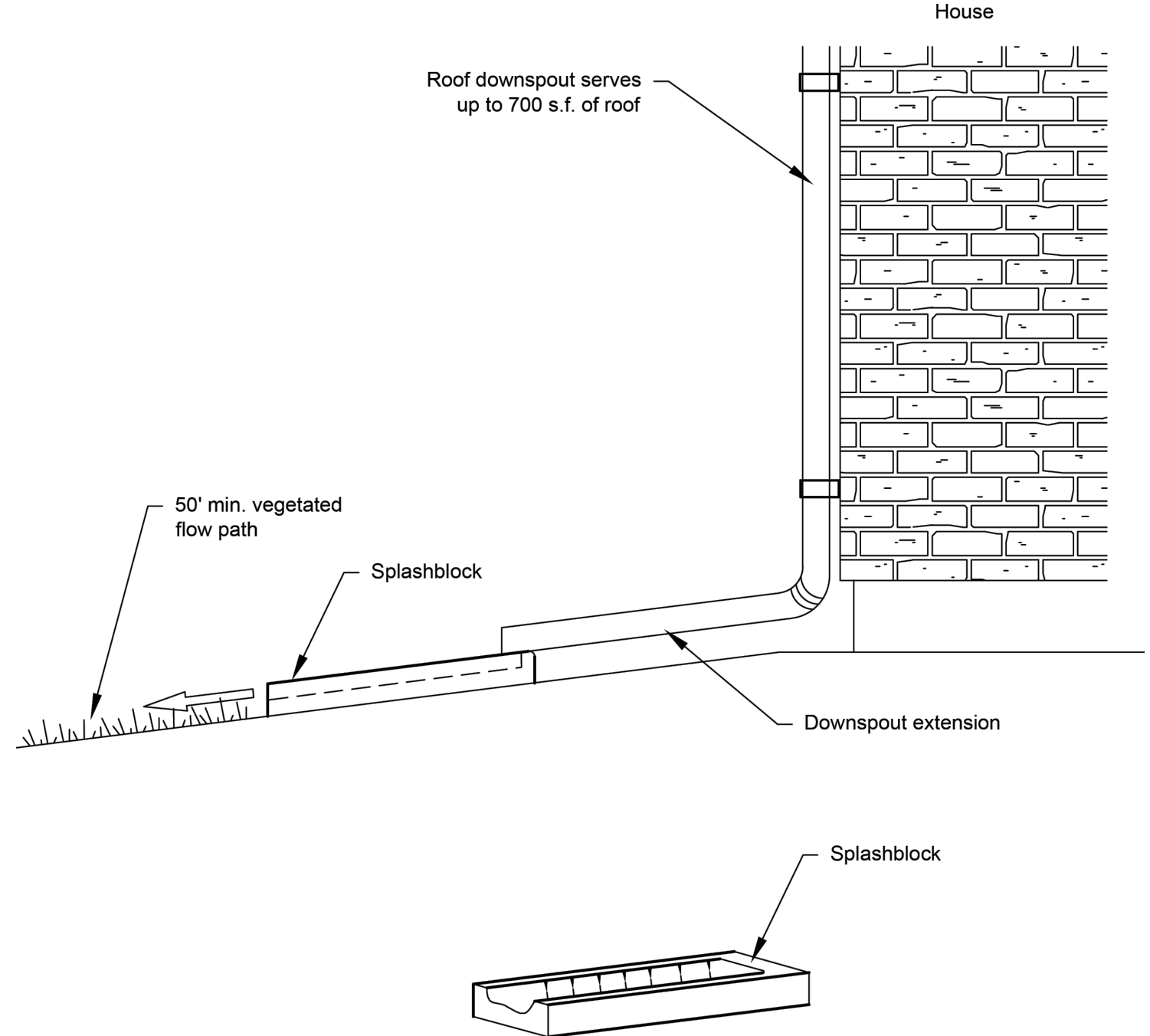
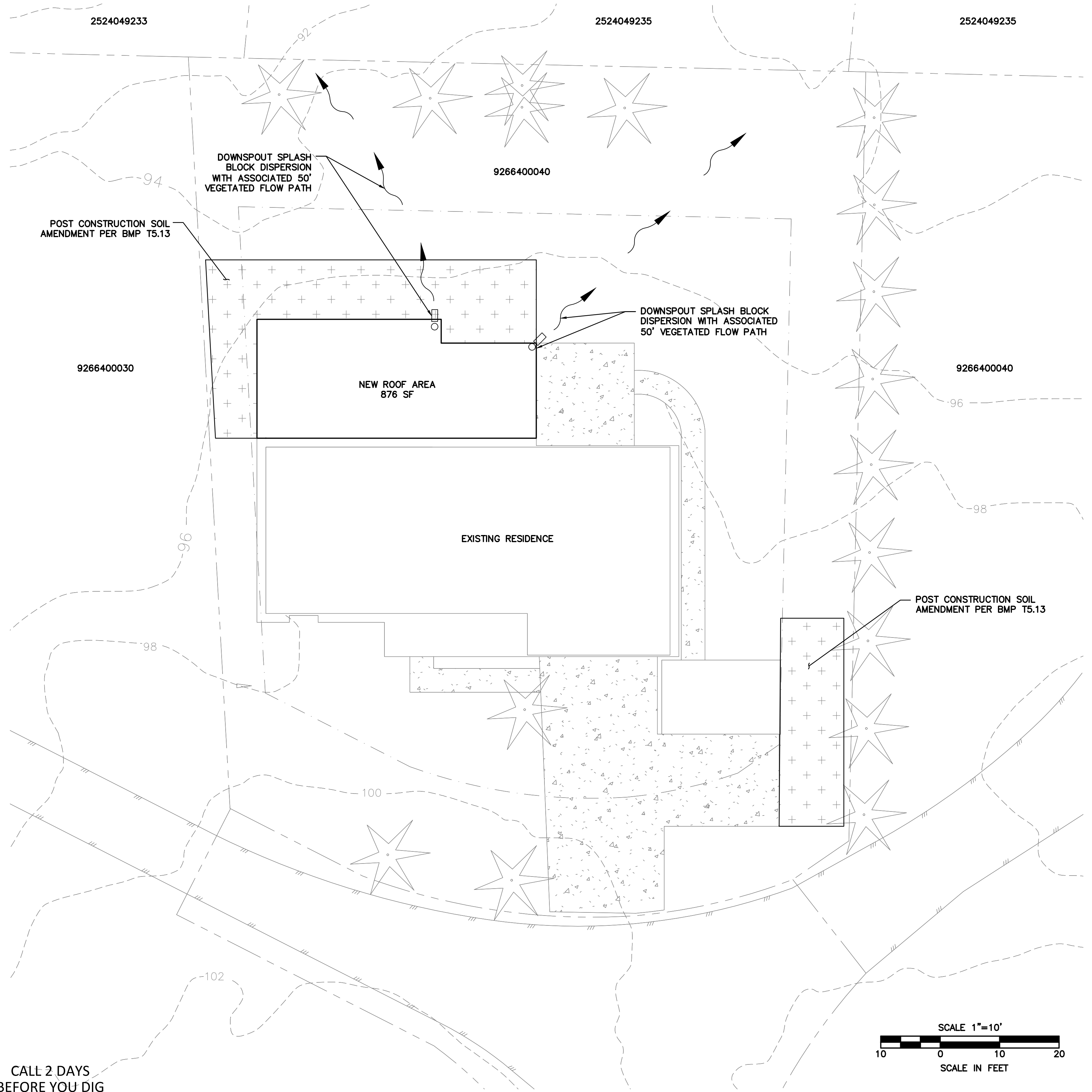

DOWNSPOUT SPLASH BLOCK DISPERSION
NOT TO SCALE

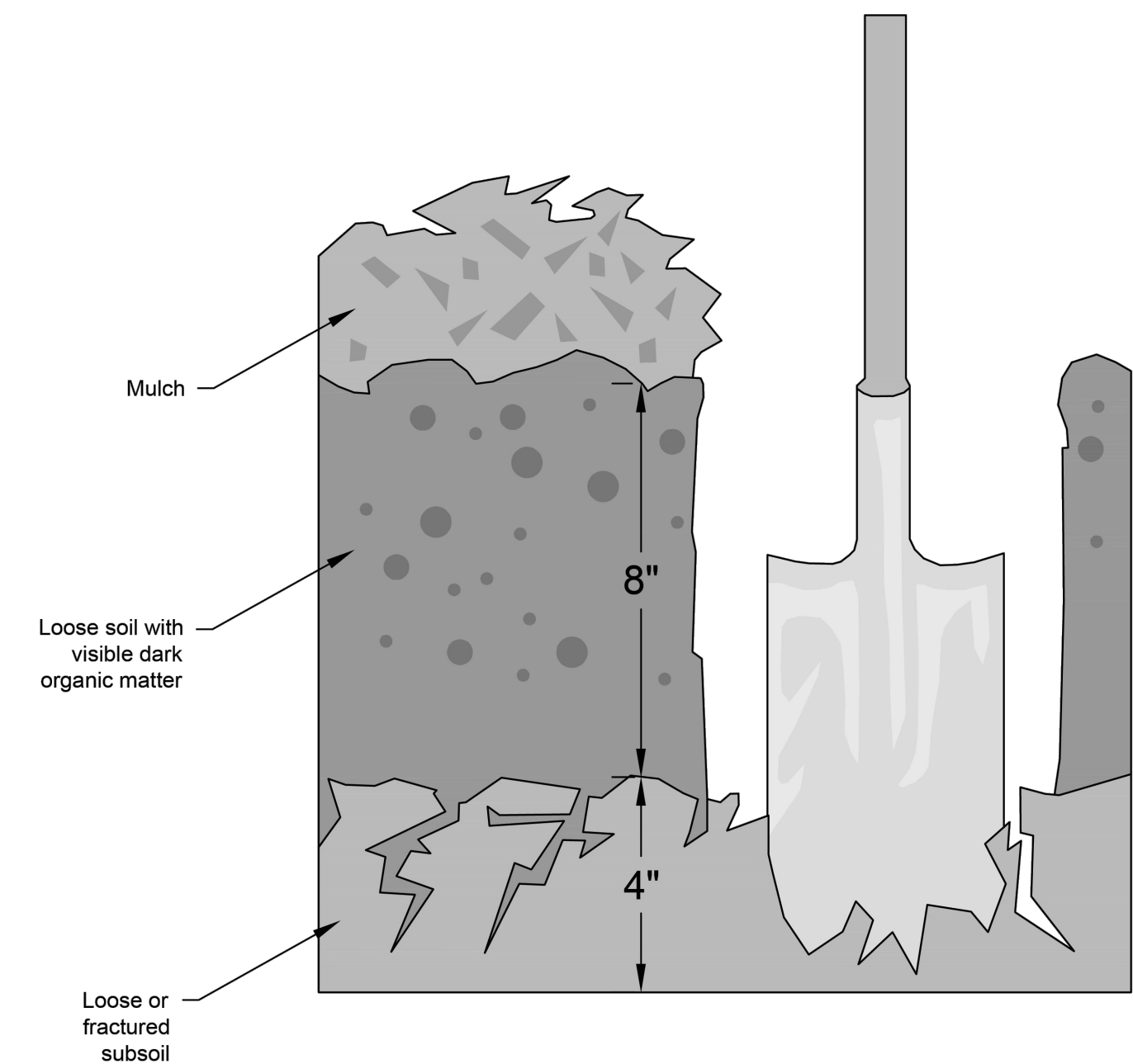

SOIL AMENDMENT NOTES

IMPORT TOPSOIL MIX WITH 5 PERCENT (TURF) OR 10 PERCENT (PLANTING BEDS) SOIL ORGANIC MATTER CONTENT. WHERE SUBSOIL IS TOO ROCKY, COMPACTED OR POORLY DRAINED TO AMEND EFFECTIVELY, A TOPSOIL MIX WITH 5 PERCENT (TURF) OR 10 PERCENT (PLANTING BEDS) SOIL ORGANIC MATTER CAN BE IMPORTED AND PLACED ON THE SURFACE. •IMPORT AND APPLY A TOPSOIL MIX:— FOR TURF AREAS: A SOIL MIX INCLUDING 20–25 PERCENT COMPOST BY VOLUME, OR A MIX WITH A LAB TEST DOCUMENTING 5 PERCENT SOIL ORGANIC MATTER.— FOR PLANTING BEDS: A SOIL MIX INCLUDING 35–40 PERCENT COMPOST BY VOLUME, OR A MIX WITH A LAB TEST DOCUMENTING 10 PERCENT ORGANIC MATTER. •THE SOIL DEPTH SHOULD BE 8 INCHES AND THE PH SUITABLE FOR PROPOSED PLANTS. ASK TOPSOIL SUPPLIERS FOR TEST RESULTS OF THEIR PRODUCT TO VERIFY THE MATERIAL CONTAINS THE DESIRED ORGANIC MATTER CONTENT AND PH. RETAIN TEST RESULT REPORTS AND RECEIPTS FOR MATERIAL DELIVERED TO THE SITE, AS THEY WILL BE USED DURING INSPECTION TO VERIFY THAT THE SOIL REQUIREMENTS HAVE BEEN MET. •FOR BEST RESULTS, PLOW OR TILL COMPACTED SUBSOIL AT LEAST 2 INCHES DEEP BEFORE APPLYING TOPSOIL MIX, AND/OR ROTOTILL SOME OF THE NEWLY APPLIED TOPSOIL INTO THE SUBSOIL.

POST CONSTRUCTION SOIL AMENDMENT

NOT TO SCALE

CALL 2 DAYS BEFORE YOU DIG
1-800-424-5555

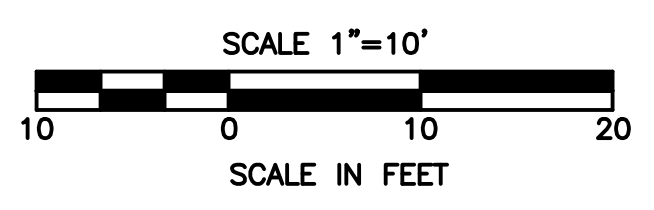

REVISIONS		NO.	DESCRIPTION	BY	DATE
1					
2					
3					
4					
5					
6					

PROJECT NO:		N/A
SURVEYED BY:	GIS	
DESIGNED BY:	DAW	
DRAWN BY:	DAW	
CHECKED BY:	DS	
DATE:		5/JUL/2025

ALDRICH RESIDENCE
DRAINAGE PLAN

3 OF 3